

LEGEND INSTRUMENT BOARD AND CONTROLS

- | | |
|--|--------------------------------------|
| 1. SWITCH BRUSHES MOTOR | 7. RESTORABLE FUSE BRUSHES MOTOR |
| 2. SWITCH SUCTION MOTOR | 8. SWITCH WITH KEY (OPTIONAL) |
| 3. PUSH BUTTON BRUSH RELEASE (not available) | 9. LEVERS FOR PRESENCE |
| 4. HOUR METER (not available) | 10. LEVER SOLUTION VALVE |
| 5. SIGNAL LAMP FOR PRESENCE OF THE TENSION | 11. LEVER SQUEEGEE LIFTING |
| 6. SIGNAL LAMP SOLENOID VALVE ON (OPTIONAL) | 12. PEDAL BRUSHES BASE GROUP LIFTING |

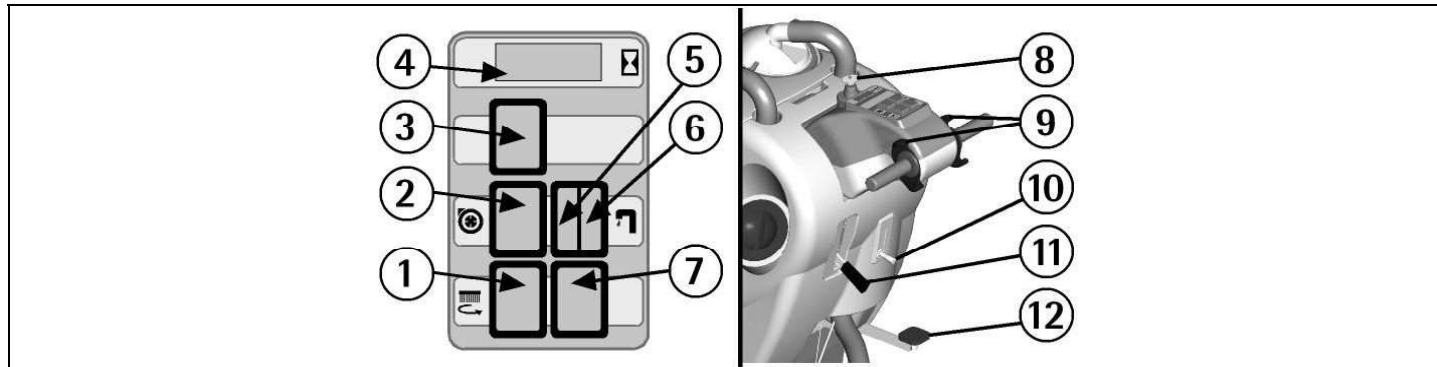

LEGEND MACHINE

- | | |
|--|--------------------------------------|
| 1. CASTOR WHEELS | 12. SWITCH WITH KEY (OPTIONAL) |
| 2. WHEELS | 13. INSTRUMENT BOARD |
| 3. ADJUSTMENT BRUSHES INCLINATION (OPTIONAL) | 14. LEVERS FOR PRESENCE |
| 4. BRUSHES BASE GROUP | 15. HANDLE BARS |
| 5. SOLENOID VALVE (OPTIONAL) | 16. MAINS PLUG FOR CABLE |
| 6. SOLUTION TANK | 17. SUPPORT CABLE BLOCK |
| 7. SCREW CAP FOR INLET DETERGENT SOLUTION | 18. LEVER SOLUTION VALVE |
| 8. RECOVERY TANK | 19. LEVER SQUEEGEE LIFTING |
| 9. PLUG EXHAUST HOSE RECOVERY TANK | 20. PEDAL BRUSHES BASE GROUP LIFTING |
| 10. INLET OPENING SQUEEGEE HOSE | 21. SQUEEGEE HOSE |
| 11. SUCTION COVER | 22. MAINS CABLE |
| | 23. SQUEEGEE ASSEMBLY |
| | 24. GUIDE SPRING SQUEEGEE HOSE |

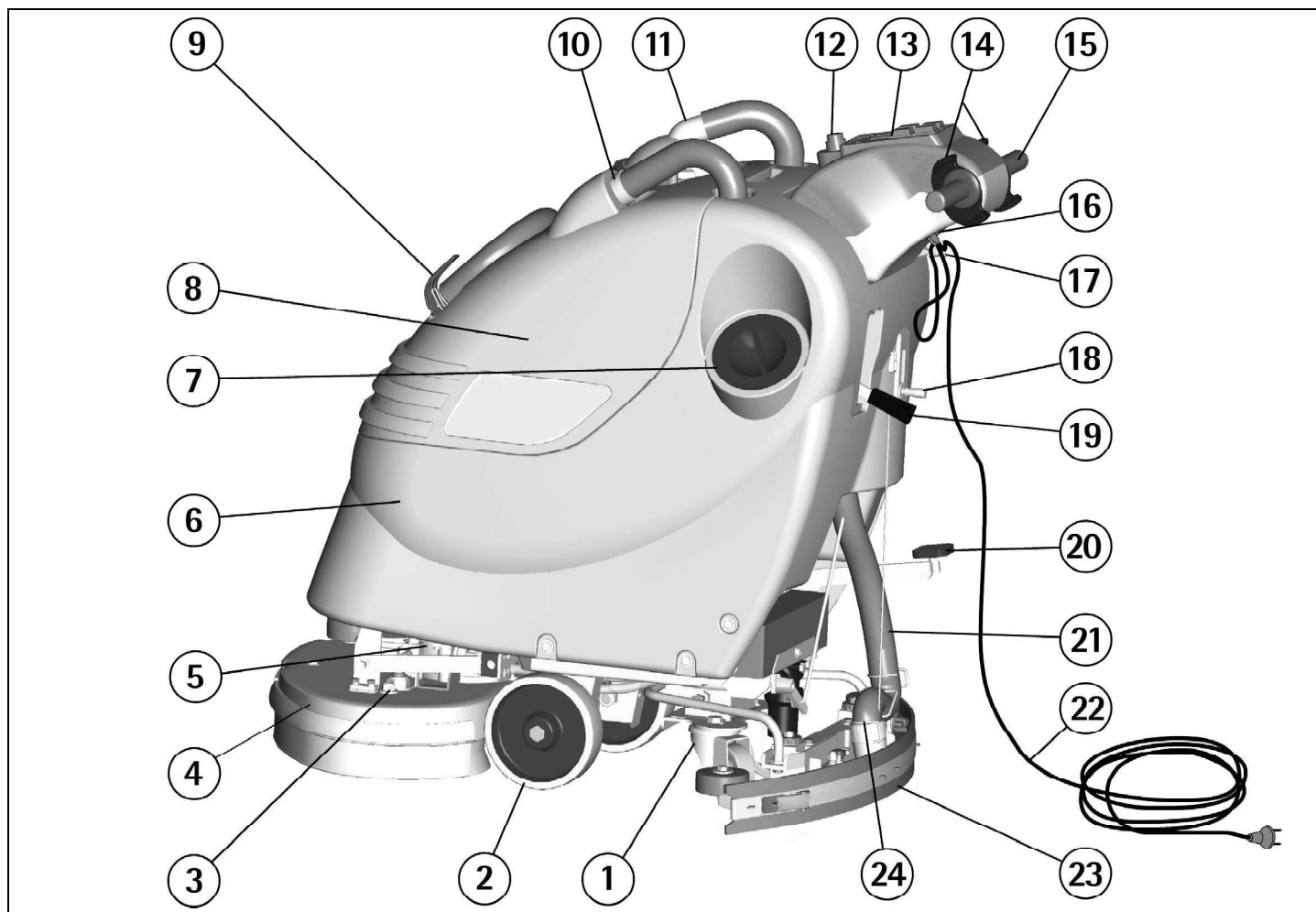

OPTIONAL ACCESSORIES

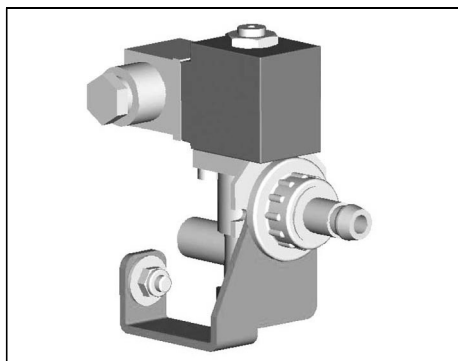

Solenoid valve

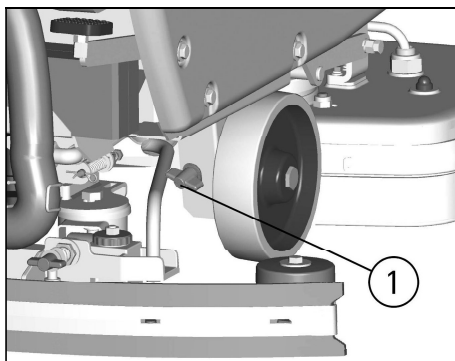

Adjustment brushes pressure

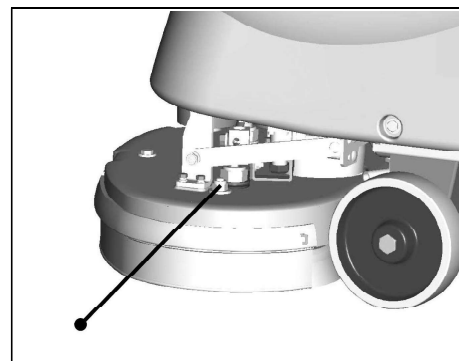

Adjustment brushes inclination



Emptying device of the solution tank

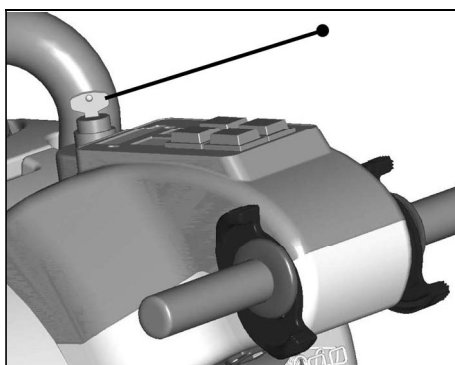

Switch with key

TECHNICAL DESCRIPTION	U/M	ruby 45e	ruby 55e
Cleaning width	mm	450	550
Squeegee width	mm	770	770
Working capacity, up to	sqm/h	1575	1925
Brushes diameter	mm	2x235	2x285
Brushes rpm	rpm	432	345
Pressure on the brushes	kg	22 max	25 max
Brushes motor	W	1000	1000
Type of drive		semi-aut.	semi-aut.
Maximum gradient		2%	2%
Suction motor	W	450	450
Suction vacuum	mbar	110	110
Solution tank	l	45	45
Recovery tank	l	48	48
Machine length	mm	1102	1140
Machine height	mm	1033	1033
Machine width (without squeegee)	mm	527	586
Weight of the machine (empty)	kg	85	87
Mains cable (length)	m	20	20
Power supply	V~	230	230
Frequency rate	Hz	50	50
Noise level	dB(A)	66,3	66,3
Level of vibration	m/sqs	0,45	0,45
Class		I	I
Protection level	IP	23	23